



PROJECT		DETAILED SPECIFICATIONS	INTEGRABLE UNDER-WORKTOP FREEZER
LOCATION	KITCHEN	ITEM CODE	SUIG 1514 COMFORT
FINISH	WHITE	MANUFACTURE	LIEBHERR
		DATE	11/07/2020

Features



Output and Consumption

Energy efficiency class	A++
Energy consumption in 24h	0.403 kWh / 24h
Energy consumption per year	148 kWh/a
Climate class	SN-T
Noise level	36 dB
Net capacity, total	95 l
Gross capacity, total	98 l
Voltage	220-240 V ~
Frequency	50/60 Hz
Connection rating	1.3 A

Dimension and Weight

Aperture height	82 - 88 cm
Dimension (packaged), H/W/D	883.0 / 615.0 / 617.0 mm
Aperture dimensions height/width/depth	82 - 88 / 60 / 55.0 cm
Weight (without packaging)	36.5 kg
Weight (with packaging)	39.0 kg

Control and Functions

Control	Magic Eye with LC and digital temperature display
Control unit	Buttons
Temperature display	Freezer compartment
Malfunction: Warning signal	Optical and acoustical
Door open: Warning signal, freezer compartment	Visual and audible
SuperFrost	Time-controlled

Freezer Compartment

Star-coding	4
Storage time during interruptions in power supply	24 h
Freezing capacity in 24 hrs	12 kg
Drawers	3
Storage shelf material, freezer compartment	Glass
FrostSafe-System	With completely enclosed, transparent drawers

Set - up and Installation

Door assembly	Door-on-door
Door hinges	Right interchangeable
Door opening angle	115°
Ventilation	Plinth ventilation

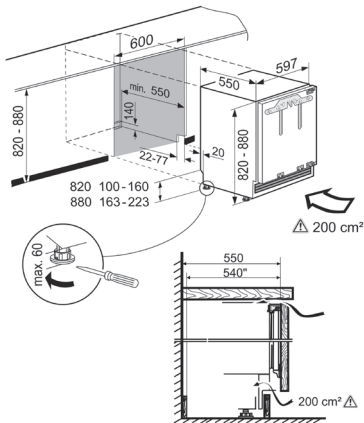

CONTACT :
MOBILE :
E-MAIL :

MVP APPLIANCES
No. 1,11 B Street, Al Quoz Industrial Area 4, Dubai - UAE
Tel : +971 4 380 9490 | Fax : +971 4 346 5614
WEBSITE: www.mvpappliances.com